

## Comus Group of Companies

## PRODUCT DATA SHEET

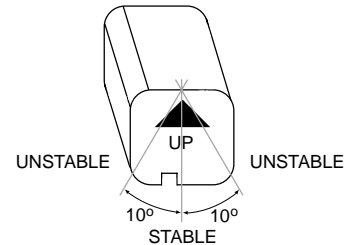
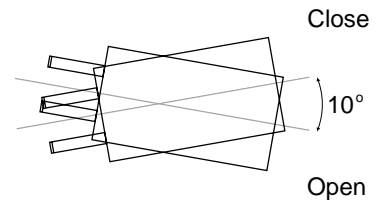
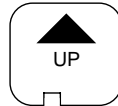
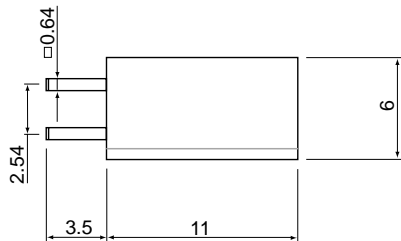
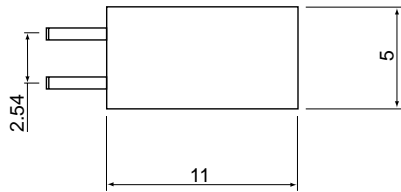

Drawings not to scale  
All dimensions in mm nominal

## SPECIFICATION

CONTACT FORM / STYLE	Dependant on position (see above)
SWITCHING VOLTAGE	24Vdc
SWITCHING CURRENT	25mA
CONTACT RESISTANCE	Initial 5Ω max. 10Ω after life test
OPERATING TEMPERATURE	-25°C to +70°C
STORAGE TEMPERATURE	-40°C to + 85°C
CASE MATERIAL	Glass Fibre Polyamide, UL94V-0
CABLE / TERMINATION	Pin
OPERATION LIFE	100,000 Cycles
FEATURES	Mercury Free Contacts
OTHER MATERIALS	Terminal: Copper Alloy, Gold plated over Nickel

NOTE: When cutting or bending switch leads it is important that the glass seal is not damaged. The cutting or bending point should be no closer than 3mm to the glass to metal seal and the lead should be supported between the cutting or bending point and the glass to metal seal.

**TILT SWITCH - Mercury free contacts**

PART NUMBER

**RBS 04 01 00**

Rev. No.	Revision Note	Date	Signature
A	Website 2003	5th Dec 03	NG

The Comus Group of Companies consist of:

Assemtech Europe Ltd  
Comus International  
Günther Belgium  
Günther France



As part of the company policy of continued product improvement, specifications may change without notice. Our sales office will be pleased to help you with the latest information on this product range and the details of our full design and manufacturing service. All products are supplied to our standard conditions of sale unless otherwise agreed in writing.